

# Xantrex™ Communications Gateway



xanbus.  
ENABLED

### Xantrex™ Communications Gateway helps the user stay informed with computer access or a simple report

The Xantrex™ Communication Gateway bridges the gap between a Xantrex GT or XW System and the system owner's computer, making it the central component for a residential or small commercial remote monitoring system.

The Gateway logs performance data directly from the Xantrex GT or XW System, and transmits it to the included Yahoo™ Widget based monitoring software for a simple and graphically rich view of system performance. More than a data logger, the Gateway offers a web page with the ability to configure automated email reports and fault status to the user or installer.

The Gateway includes both built-in Wi-Fi and Ethernet connectivity allowing for flexible and simple set up for wireless or wired connection to a router or direct to a PC.

### The Gateway logs and transmits performance data such as:

- ▶ System power production
- ▶ Inverter specific power production
- ▶ Lifetime energy production; daily, weekly, monthly energy production graphs
- ▶ Inverter faults with date and time stamp

### Product Features

- ▶ Can monitor a network consisting of up to 20 single phase GT inverters and up to 8 XW devices (XW inverter(s), XW Charge Controller(s), XW SCP, and XW AGS)
- ▶ Wi-Fi/Ethernet module with 10/100 Base-T or 802.11 b/g
- ▶ Can be configured to send energy and alarm reports via email
- ▶ Graphical interactive solar monitoring software
- ▶ Embedded web page for configuring the Gateway and upgrading inverter firmware
- ▶ 16 megabytes of storage

### Xantrex Technology Inc.

#### Headquarters

8999 Nelson Way  
Burnaby, British Columbia  
Canada V5A 4B5  
+1 800 670 0707 Toll Free  
+1 604 420 1591 Fax

#### Europe

Xantrex Technology GmbH  
Steinheimer Str. 117  
63500 Seligenstadt, Germany  
+49 (0) 6182 81 6000 Tel  
+49 (0) 6182 81 6001 Fax

Xantrex Technology S.L.  
Bac de Roda, 52 edificio A  
08019 Barcelona, Spain  
+34 93 433 8350 Tel  
+34 93 433 8351 Fax

europesales@xantrex.com



Our evolution to Schneider Electric, the global specialist in energy management, re-affirms our commitment to provide you with innovative solutions, best-in-class customer service, and exceptional quality in everything we do. We are proud to be your partner, and we are dedicated to helping you make the most of your energy.

[www.xantrex.com](http://www.xantrex.com)

## Xantrex™ Communications Gateway

Electrical Specifications	
Communication	Physical layer 2, CAN
Communication protocol	Xanbus™
Maximum Xanbus cable length	130 ft (40 m)
Maximum Ethernet cable length	195 ft (60 m)
Connectors	3 RJ-45 – 8 pins (2 Xanbus, 1 Ethernet)

Communication Specifications	
Ethernet	IEEE Std 802.3™-2005
Wireless	802.11.4b and 802.11.4g; WEP and WPA security Channels 1-11 (US/Canada), 1-9 (Europe)
Part number	865-1055 (US/Canada), 865-1056 (Europe)

Mechanical Specifications	
Dimensions (H x W x D)	4 x 6 x 1" (112 x 190 x 45 mm)
Height including antenna	9" (249 mm)
Weight	0.46 lb (207 g)

Regulatory Compliance	
North America	EMC FCC part 15B class B
Industry Canada	ICES-003 class B
Europe	
Safety	Low Voltage Directive 2006/95/EC EN60950-1:2001
EMC	EMC Directive 2004/108/EC EN55022 A2: 2003 EN55024 A2: 2003
Telecom	R&TTE Directive 1999/5/EC ETSI EN 301 489-1 ver. 1.6.1 ETSI EN 301 489-17 ver. 1.2.1

Specifications subject to change without notice.

## Sample Configuration

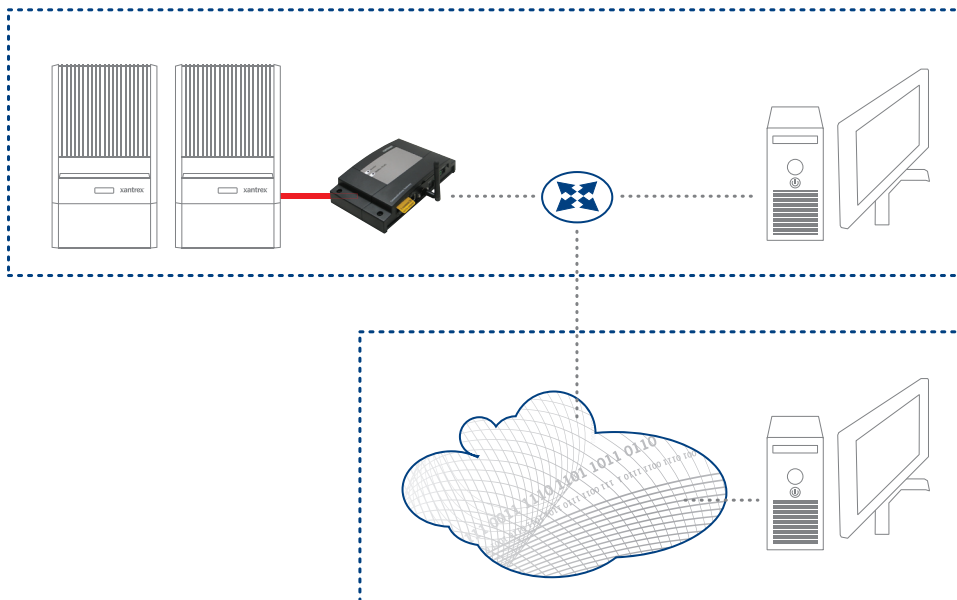

## Yahoo™ Widget-based Monitoring Software

(Sample screen shots)

